

CV CX

Art.-Nr.: 91400, 91500, 91600



- 1) Rokamat CV C 43-130 (25BR1ACX0001)
Rokamat CV C 43-200 (25BR2ACX0001)
Rokamat CV C 43-300 (25BR3ACX0001)
- 2) 2006/42/EG, 2011/65/EU, 2014/30/EU, 2012/19/EU,
EG No. 1907/2006, EU 2023/988
- 3) EN 62841-1:2015 + AC:2015 + A11:2022, EN 60745-2-12:2009,
EN ISO 12100:2010-11
- 4) Kammerer GmbH, An der B 10, 75196 Remchingen

Remchingen, 01.05.2025

Beate Kammerer
Head of Technical Documentation

ROKAMAT

Kammerer GmbH
An der B 10
75196 Remchingen
Deutschland



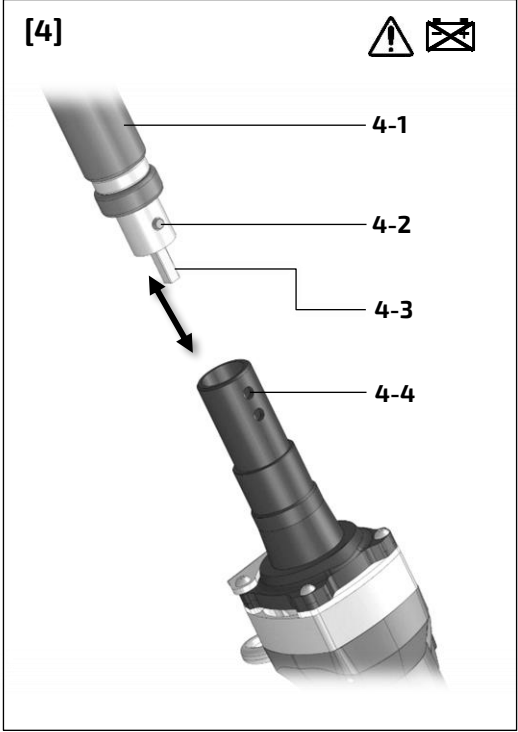
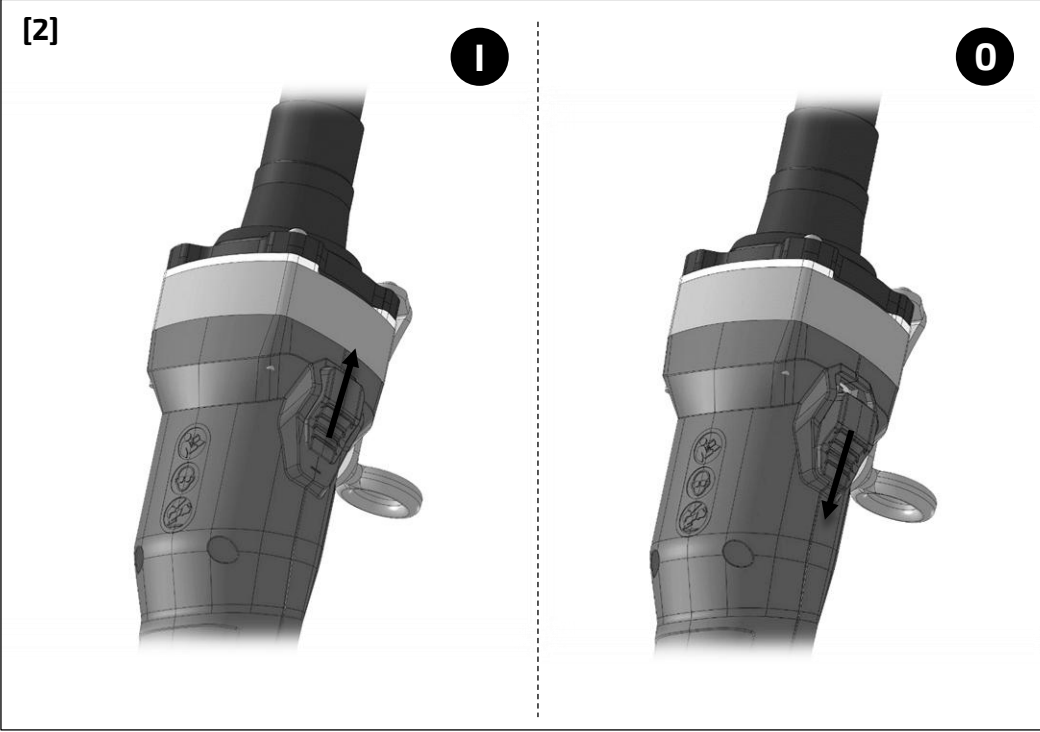
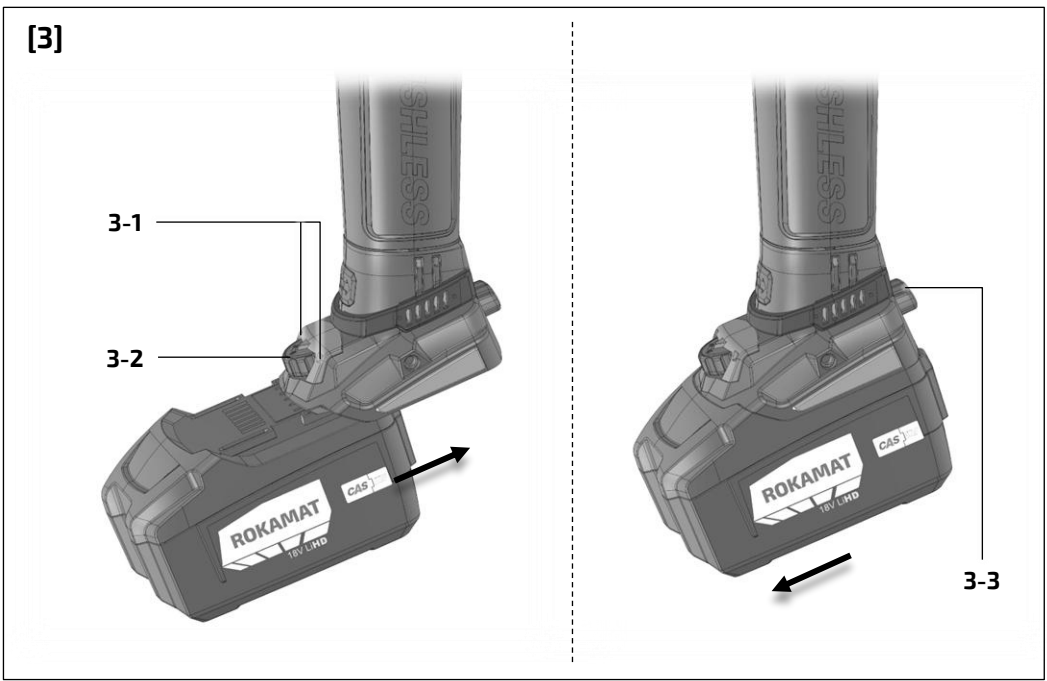
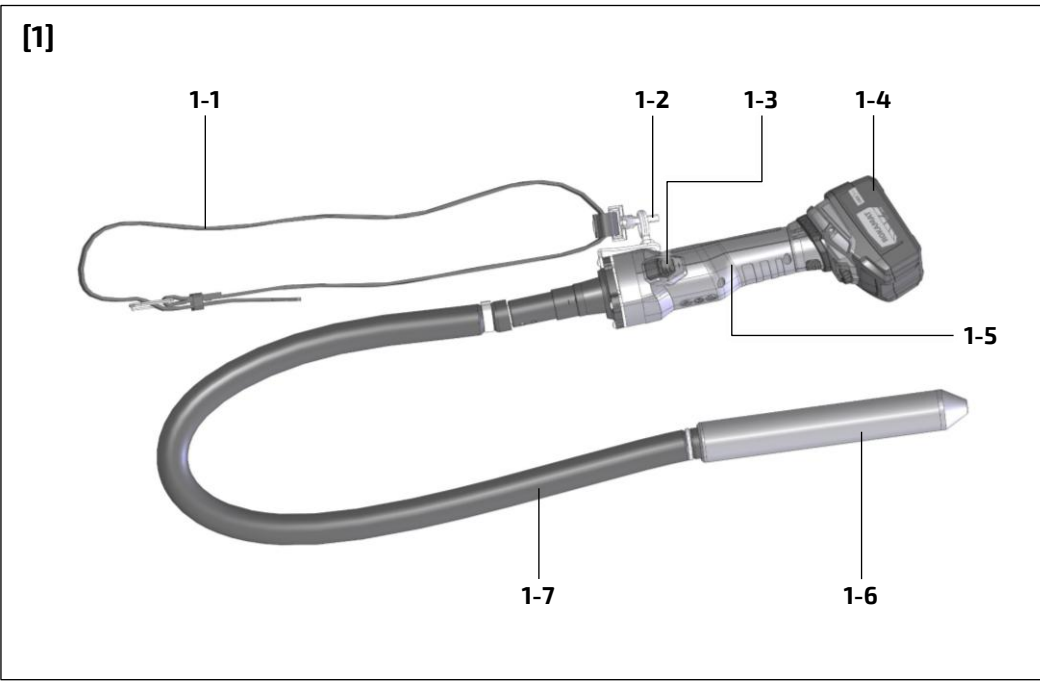

Contents

1. Symbols	3
2. Safety Instructions	3
3. Intended Use	3
4. Device Components.....	3
5. Commissioning.....	3
6. Instructions for Use.....	4
7. Maintenance and Care.....	4
8. Spare Parts and Accessories.....	4
9. Environmental Protection.....	4
10. Declaration of Conformity.....	4
11. Technical Specifications	5
12. Troubleshooting	5

1. Symbols



WARNING! Denotes impending danger. Non-observance of this warning may result in death or extremely severe injuries. *)



CAUTION! Denotes a possibly dangerous situation. Non-observance of this warning may result in slight injury or damage to property. *)



Risk of electric shock!



Read operating instructions and safety notices! *)



Wear protective goggles! *)



Wear ear protection!



CAS Li-Ion battery pack *)



Removing battery pack!



Do not dispose of as domestic waste! *)



Important advice/information

d.c. Direct Current (DC) *)

1, 2, 3 ... Thumbwheel settings (Speed settings. Higher number means greater speed) *)



Confirms the conformity of the power tool with the directives of the European Community. *)

*) These symbols are (also) on the device.

2. Safety Instructions

For your safety



WARNING!

Read all safety warnings, instructions, illustrations and specifications provided with this power tool. Failure to follow all instructions listed below may result in electric shock, fire and/or serious injury.

Save all warnings and instructions for future reference.



Do not use this power tool before you have thoroughly read and completely understood this Instruction Manual, the enclosed "General Power Tool Safety Warnings", instructions for battery packs and chargers.

The documents mentioned should be enclosed with the power tool, should it be passed on or sold.

Please also observe the relevant national industrial safety regulations.

Special Safety Instructions for Concrete Vibrators

Always keep your hands and face away from vibrating head when operating.

Switch off the tool immediately if you notice abnormal noise or something faulty during operation.

Inspect the tool carefully for breakage, cracks or deformation if you accidentally drop it or strike it against something.

Do not set the tool down and switch it on. The vibrating head may whip around out of control and cause an accident.

Wear appropriate safety goggles if necessary.

Hold the tool only by the designated gripping surface.

Safety instructions for the protection of the electrical appliance

Be careful not to allow water, wet concrete or the like to get into the tool. Do not let the motor fall into wet concrete.

Don't put the running motor on the ground! Dirt may get sucked in and cause damage.

Do not bend the flexible drive shaft.

Emission levels

NOTE! Values for the A-weighted sound pressure level and for the total vibration values can be found in the "Technical specifications" table at chapter 4.

These values have been measured in accordance with a standardised test and may be used to compare one tool with another. They may also be used for a preliminary assessment of exposure.

WARNING! The indicated measurements refer to new power tools represent the main applications of the tool. However, if the tool is used for different applications, with different accessories or poorly maintained, the vibration and noise emissions during actual use of the power tool may differ from the declared values (significantly increased over the total working period).



CAUTION!

During operation the noise level can exceed 80 dB(A).

Wear ear protection!

Identify additional safety measures to protect the operator from the effects of vibration such as: maintain the tool and the accessories, keep the hands warm, organization of work patterns. An estimation of the level of exposure to vibration should also take into account the times when the tool is switched off or when it is switched on but running without load. This may significantly reduce the exposure level over the total working period.

Environmental conditions for machine, battery and charger

Operation

Temperature range: 0 °C to +50 °C

Humidity: ≤ 85 %, non-condensing

Climate: dry

Transport and storage

Temperature range tool: -5°C to +55°C

Temperature range battery: +10 °C and +30 °C

Humidity: 0 % to 70 %

Climate: dry, roofed, dew protected

3. Intended Use

The hand-held battery tool ROKAMAT Cordless Concrete Vibrator **CV CX** is intended for compacting fresh concrete.

Only sufficiently qualified and trained personnel is allowed to work with the Cordless Concrete Vibrator.

The intended use includes the observance of the operating instructions, in particular the safety instructions and the observance of generally recognized accident prevention regulations.

Any use other than the intended use described above is considered misuse. The manufacturer accepts no liability or warranty for misuse of the machine.

4. Device Components

The specified illustrations can be found in fig. [1] on page 2 of the operating instructions.

- 1-1 Belt
- 1-2 Snap hook
- 1-3 Slide switch
- 1-4 Battery
- 1-5 Motor (with gripping surface)
- 1-6 Vibrating piece
- 1-7 Flexible drive shaft

5. Commissioning



CAUTION!

Before switching on the power tool: Unpack power tool and accessories and check that no parts are missing or damaged.

Do not use this power tool until you have thoroughly read and completely understood the additional the separate operating instructions for battery packs and chargers.

Motor mounting

The motor [1-5] is not allowed to be placed on the floor during operation, but must be hooked in the snap hook [1-2] of the provided belt [1-1] (resp. shoulder belt).

Switching the electric power tool on and off [2]

Switching on: Push the sliding switch [1-3] forward. For continuous activation, now tilt downwards until it engages.

Switching off: Press the rear end of the slide switch [1-3] and release it.

6. Instructions for Use

WARNING!

Risk of injury, electric shock!

Only use CAS-compatible chargers / batteries with a rated voltage of 18 V DC!

Charging the battery

See separate operating instructions for battery packs and chargers.

Installing or removing battery pack [3]

CAUTION!

Risk of injury!

When removing and inserting the battery pack, hold the machine in such a way that the on/off switch cannot be actuated unintentionally!

To insert: Slide the battery pack [1-4] in until it engages.

To remove: Press the battery pack release button [3-3] and pull the battery pack downwards and out.

Adjusting the speed [3]

Set the recommended speed using the thumbwheel [3-2]. (Lower number = lower speed; higher number = higher speed).

Rotating battery pack [5]

The rear section of the machine can be rotated 270° in three stages, thus allowing the machine's shape to be adapted to the working conditions. Only operate the machine when it is in an engaged position.

General Use

Hold the tool straight when inserting/operating. Use the tool within the effective vibration range at equidistant intervals. The effective air bubble removal range is about ten times the diameter of the vibrating head, or around 420 mm.

ADVICE!

Do not use this tool to move concrete within a form. The mortar will just move away and the coarse aggregate will remain, causing segregation.

Effective leveling and removal of air bubbles

Removal of the air bubbles is complete after you have worked the tool throughout each effective range, the concrete stops shrinking, and the mortar has risen evenly to the surface, giving off a light appearance. Gently remove the operating tool not to leave holes.

ADVICE!

Vibrating too long in a single place causes concrete segregation. When the coarse aggregate segregates when placing concrete, shovel out the coarse aggregate and put it where there is plenty of mortar. Then use the tool on it. Don't leave coarse aggregate in the segregated condition.

When concreting a slope site, always pour from the bottom at the beginning. This way the weight of the freshly poured concrete and vibration will lead to effective removal of air bubbles. Conversely, if the pouring is done first from above, the mortar will separate and eventually slide to the bottom.

After finishing work

Use a wet cloth or the like to carefully wipe off any wet concrete left on the tool after use. Extra care should be given to thorough cleaning of the vents, switch area, cover openings, etc.

7. Maintenance and Care

WARNING!

Risk of injury, electric shock!

Always be sure that the tool is switched off and the battery pack is removed before performing maintenance work on the machine!

- Repairs may be carried out by an authorized customer service center only.
- Repairs to electrical tools must be carried out by qualified electricians ONLY!

During the warranty period do not loosen the screws on the housing. Non-compliance will deem the warranty obligations of the manufacturer null and void.

Remove dust from the motor and battery regularly

It is possible that particles deposit inside the power tool during operation. This impairs the cooling of the power tool. Conductive build-up can impair the protective insulation of the power tool and cause electrical hazards.

The power tool should be cleaned regularly, often and thoroughly through all front and rear air vents using a vacuum cleaner or by blowing in dry air. Prior to this operation, remove the battery pack and wear protective glasses and dust mask.

Transport and storage

WARNING!

Risk of damage to the power tool!

Remove the battery from the tool before transporting it!

Transport and store the power tool only in its original carrying case.

Replacement of the flexible drive shaft [4]

CAUTION!

The two boreholes for the push button at the drive shaft serve as length adjustment between shaft core and protective hose. The shaft core should be freely movable in length and must not get compressed!

Disassembling: On the motor side, press in the press button [4-2] in the borehole [4-4] with a tool (e.g. screwdriver) and pull out the protective hose [4-1]. Now the shaft core [4-3] can be replaced.

Mounting: In reverse order. Make sure that the shaft core [4-3] is threaded into the square in each case.

ADVICE!

Check all wearing parts once a month.

8. Spare Parts and Accessories

Other accessories, in particular insertion tools, can be found in the manufacturer's catalogues. Exploded drawings and spare-part lists can be found on our homepage: www.rokamat.com.

Use only original ROKAMAT spare parts and work tools.

9. Environmental Protection

Observe national regulations on environmentally compatible disposal and on the recycling of disused machines, packaging and accessories.



For Great Britain and EU countries: Do not dispose of electric equipment or battery pack together with household waste material! In observance of the European Directives, on Waste Electric and Electronic Equipment and Batteries and Accumulators and Waste Batteries and Accumulators and their implementation in accordance with national laws, electric equipment and batteries and battery pack(s) that have reached the end of their life must be collected separately and returned to an environmentally compatible recycling facility.

ADVICE!

Please ask your dealer about disposal options!

10. Declaration of Conformity

It is expressly declared that the Cordless Concrete Vibrator listed on the first page under 1) from the serial number indicated onwards complies with all relevant provisions of the directives or regulations listed in 2) and that the harmonized standards listed in 3) have been applied. The technical documentation is available from the authorized documentation agent named in 4).

12. Technical Specifications

Cordless Concrete Vibrator CV CX Art.-Nr. 91400, 91500, 91600			
Model	CV CX 43-130	CV CX 43-200	CV CX 43-300
Voltage of battery pack	18 V DC		
Flexible shaft assembly length	130 mm	200 mm	300 mm
Vibration head (diameter x length)	43 x 310 mm		
Overall length (without battery pack)	1860 mm	2550 mm	3565 mm
Net weight (without battery pack)	4.9 kg	5.5 kg	6.0 kg
A-weighted sound pressure level (see "Emission levels" in cap. 2):			
Sound pressure level L_{pA}	80 dB(A)		
Sound power level L_{WA}	91 dB(A)		
Uncertainty K_{pA}, K_{WA}	3 dB		
Total vibration value (see "Emission levels" in cap. 2):			
Emission value a_h	17.5 m/s^2		
Uncertainty K	1.5 m/s^2		

13. Troubleshooting

Problem	Possible causes	Remedy
The electronic signal display [5-1] lights up and the load speed decreases.	The temperature is too high!	Run the machine in idling until the electronics signal indicator switches off.
The electronic signal display [5-1] and the machine does not start.	The restart protection is active. The machine will not start if the battery pack is inserted while the machine is on.	Switch the machine off and on again.
Motor power fluctuates.	Carbon brushes worn.	Replace carbon brushes.
CV CX not working.	Battery discharged.	Charge battery.

If problems other than those listed occur, please contact your ROKAMAT service workshop or your local specialist.